



- Small size 82 x 63 x 28 mm
- IP67 certified
- 1-Wire interface
- Low power consumption
- Internal power supply available (ECO4+)

PHYSICAL PROPERTIES

Dimensions, mm	82 x 63 x 28
Connector	12pin
Indication	3 LEDs
Housing	Plastic
Protection	IP67

PRODUCT FAMILY

- ◆ **ECO4\ECO4+**
- ◆ ECO3
- ◆ PRO4
- ◆ PRO3
- ◆ TCO4
- ◆ TCO3

CONTACTS

- ☎ +370 5 272 65 70
- ✉ info@ruptela.com
- 🌐 www.Ruptela.com

Electrical specification

Power supply	12/24 V DC (range:10 - 32 V DC)	
Absolute maximum ratings	50 V @ 60 s	
(on ECO4+)	72 V @ 0.1 s	
Power consumption	ECO4	ECO4+
Deep sleep mode @ 12 V	6 mA*	7 mA*
Normal mode, battery not charging/full battery @ 12 V	60 mA	60 mA
Normal mode, battery charging @ 12 V	×	Max. 200 mA
Internal supply (ECO4+)	Li-Po 3.7 V 190 mAh	
Storage		
Internal storage	4 MB (min. 30000 records)	
Protections		
Short circuit protection		
Reverse polarity protection		
Electrostatic discharge protection on USB		
Electrostatic discharge protection on 1-wire data		
Over-current protection on 1-Wire power		
Electrostatic discharge protection on sim card slot		
Charging protection (on ECO4+)**		

* Firmware dependent

** If temp is >45C, charging is disabled, if >60C battery is disconnected from the system at all

I/O Characteristics

4 x DIN	Digital inputs
Threshold	4 V
2 x DOUT	Digital outputs
Max output	Open collector 32 V, 1 A max
2 x AIN	Analog inputs
Input range	0 - 30 V
Resolution	12 bit
1 - Wire	1-Wire peripherals
5V power output	80 mA @ 5 V
USB	Configuration interface

Environmental data, reliability, certification

	ECO4	ECO4+
Storage temperature	-40 - +65	-40 - +65
Operating temperature	-35 - +60	-35 - +60
Operating from battery:		
Charging	×	0 - +45
Discharging	×	-20 - +60
Operating altitude	Up to 2000 m	
Certifications:		
E-mark	✓	✓
CE ready	✓	✓
RoHS	✓	✓
Temp. Test ISO16750	✓	✓
IP67	✓	✓

Telecommunication, Positioning

GPS\GLONASS module	Ublox MAX-7C
Internal	
56 channel	
Sensitivity	-161 dBm
Cold start	29 s
Aided start	5 s
Reacquisition	1 s
GPS antenna	External
Frequency	1575.42 ± 3 MHz
GSM modem	Quectel M95
Internal	
GSM850\GSM900\DCS1800\DCS1900	
GSM antenna	Internal
GSM850\GSM900\DCS1800\DCS1900	
Accelerometer	3-axis; 2g/4g/8g/16g

PHYSICAL PROPERTIES

Dimensions, mm	82 x 63 x 28
Connector	12pin
Indication	3 LEDs
Housing	Plastic
Protection	IP67

PRODUCT FAMILY

- ◆ **ECO4/ECO4+**
- ◆ ECO3
- ◆ PRO4
- ◆ PRO3
- ◆ TCO4
- ◆ TCO3

CONTACTS

- ☎ +370 5 272 65 70
- ✉ info@ruptela.com
- 🌐 www.Ruptela.com

Peripherals

Available on 1 - Wire

- 4 x Temperature sensors DS18B20/DS18S20
- 1 x iButton DS1990 with passive socket

Available on digital outputs

- 1 x Buzzer\LED
- 1 x Eco-drive panel

Pin out

Red	Power supply
Black	Ground
Purple	DOUT1
Orange	DOUT2
White with red stripe	1-Wire power
Green with yellow stripe	1-Wire data
Gray	AIN1
Green	AIN2
Yellow	DIN4
Pink	DIN1
White	DIN3
Blue	DIN2

Explanations

Deep sleep mode – Power saving mode when GNSS and GSM modules and all peripheral devices are disabled, except DINs and DOUTs. Device wake up on state change of any Digital Input (DIN).

Device can be installed within 45° angle in any axis but top surface facing up. Device should be installed tightly, does not move or shake.

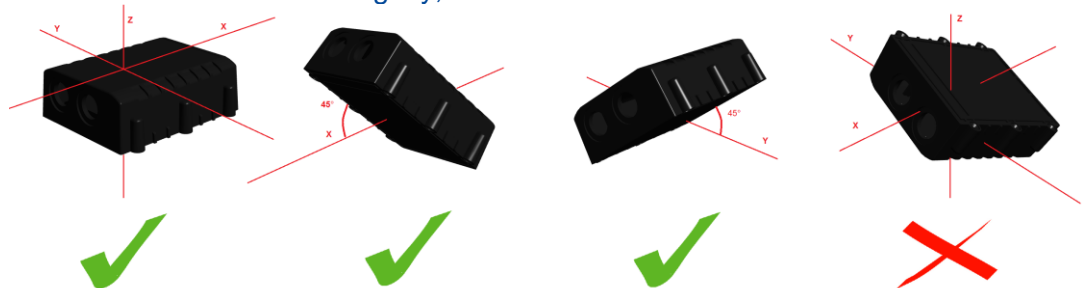

Warning!

All internal components including battery must be replaced only by manufacturer! Any self-willed attempt to open device cases will void any warranty.

Device must be installed in service access area (e.g. under dashboard, behind fuse box).

PHYSICAL
PROPERTIES

Dimensions, mm	82 x 63 x 28
Connector	12pin
Indication	3 LEDs
Housing	Plastic
Protection	IP67

PRODUCT FAMILY

- ◆ ECO4/ECO4+
- ◆ ECO3
- ◆ PRO4
- ◆ PRO3
- ◆ TCO4
- ◆ TCO3

CONTACTS

- ☎ +370 5 272 65 70
- ✉ info@ruptela.com
- 🌐 www.Ruptela.com

Device installation

- When installing device into vehicle please obey these instructions otherwise your device may not work properly.
- Device should not be seen or easily reached.
- Device should be firmly fixed to the surface. Please avoid mounting it near the metal surface or cables (see the picture below).
- Wrong device mounting may cause malfunction.
- Device cannot be fixed to heat emitting or moving parts.
- SIM card should be inserted in the device while the connector is plugged off (while device has no power).
- Device must be fitted with double sided stick tape!

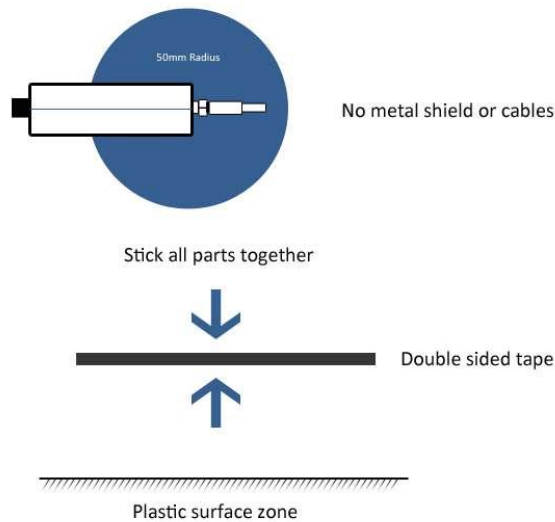

Antenna installation

It is recommended to place GPS/GLONASS antenna behind the dashboard as close to the window as possible. It must be uncovered, installed heads up (see picture).

Best place for GPS/GLONASS antenna is marked in blue (see picture).

